

Table with 2 columns: Name and Amount. Lists names like Gladys Berryman, John Boone, etc., and their corresponding amounts.

News from Nicholas County Courthouse

District Court - Oct. 21, 1980
Robert Earl Dillio, 620 Oak Street, New Boston, Ohio, no operators license, defendant failed to appear, bench warrant issued, \$150 cash bond only.

Small Claims Court -
Clyde Drevs vs Janet Angel, \$50 labor. Southern State Carlisle Coop vs Eugene Mitchell, supplemental hearing. Defendant failed to appear, bench warrant issued, \$100 cash bond.

Absolute Auction Sat., Nov. 1 at 1:30 P.M.
Located 2 blocks from Courthouse on the corner of Chestnut and Turman Ave. For the Estate of the late Mrs. G. M. Maxey.

Earl Hamm Auctioneer REAL ESTATE BROKER
Carlisle, Ky. Office Phone 289-5720; Home 289-5320

SPECIAL PUBLIC LAND AUCTION
STATE HIGHWAY NO. 32 and NO. 1455, NICHOLAS COUNTY, KENTUCKY
SATURDAY MORNING 10:00 a.m. - NOVEMBER 8, 1980

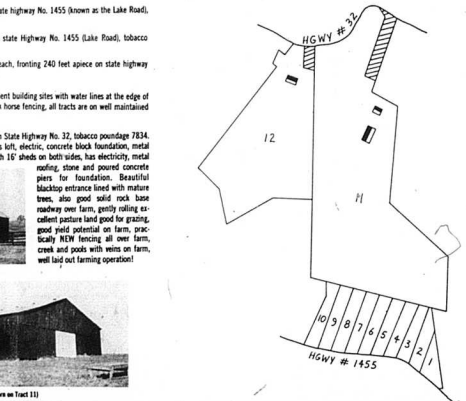

Could easily be adapted for horses, fencing in brand new! This property is bounded by the city limits of Carlisle and Nicholas County. The farm is only a stone's throw from Lake Carmac, water is available from both City and County Water Districts along with natural gas, sewer line and a few short distances, water.

McCONNELL REAL ESTATE, INC. REALTORS-AUCTIONEERS
BILL T. McCONNELL - GEORGE SCOTT, JR. - R.E. McCONNELL
BILL McCONNELL, SR. - SALESMAN
PARIS, KENTUCKY 606-887-3212 PHONES LEIGHTON, KENTUCKY 606-252-2018

Estate Sale Sat., Nov. 1 at 10 A.M.
Nicholas County Armory on Paris Road
Estate of Imogene Westfall
House and approximately 2 acres of land located on West Main St., Carlisle, Ky.

In the sale of the Personal Property you will find much "unusual" items. Many of these items have been in the Westfall family for several generations. A collection of unbelievable items which can only be appreciated if seen.

Antiques: Spinning wheel, bookcase, large cabinet for china or convertible for gun rack. High chair, library table, cherry tables, oak square table with 8 chairs, cherry chests (one with swinging doors) and 1 drawer, and one with 4 drawers), rocking chair and miscellaneous chairs, mirrors, 2 mantle clocks, "unusual" wall clock shaped like a brass bucket, wicker chair, wicker kidney shaped table, coal hod, coal bucket, jugs, crocks, churn, old fashioned pitcher and bowl for wash stand, bedside chamber, trunk, unusual ice box trunk, quills, dishes both old and modern, cut glass, ironstone tureen and platter, Gone With The Wind lamps and others, brass and marble fern stand, pictures and frames, pedestal stand, old foot operated sewing machine, sterling silver (Old Colonial), miscellaneous sterling and coin silver spoons, oil paintings, wicker baskets.

Other Items: Air conditioner (18,000 B.T.U.), cherry spool reproduction bed with springs and mattress in excellent condition, 2 electric refrigerators, Kenmore washer and dryer (set), gas kitchen stove, apartment size gas stove, kitchen utensils, pressure cooker, unusual pillows with handmade African covers (10), blankets, quilts, pillows, spreads, carpets, fans, couches, sweaters, lawn chairs, change lounge, bicycle exerciser, beds, springs & mattresses, tools (small and large), racks, boxes and other outside tools.

Owner: Miss Imogene Westfall
Charles Cox, Administrator of Estate
Fightmaster Real Estate
Larry Wilks, Broker Billy R. Hunter, Apprentice Auctioneer
Charles Cox, Broker Auctioneer Carlisle, Ky.

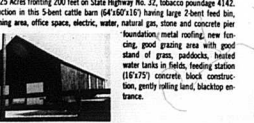

CLASSIFIED ADVERTISING RATES
Cash with order rates
CLASSIFIED ADS 12¢ per word
1-25 words \$3.00 per insertion
5-25 words \$4.00 per insertion
10-25 words \$5.00 per insertion
15-25 words \$6.00 per insertion
20-25 words \$7.00 per insertion
25-25 words \$8.00 per insertion
30-25 words \$9.00 per insertion
35-25 words \$10.00 per insertion
40-25 words \$11.00 per insertion
45-25 words \$12.00 per insertion
50-25 words \$13.00 per insertion
55-25 words \$14.00 per insertion
60-25 words \$15.00 per insertion
65-25 words \$16.00 per insertion
70-25 words \$17.00 per insertion
75-25 words \$18.00 per insertion
80-25 words \$19.00 per insertion
85-25 words \$20.00 per insertion
90-25 words \$21.00 per insertion
95-25 words \$22.00 per insertion
100-25 words \$23.00 per insertion

Absolute Auction Sat., Nov. 1 at 1:30 P.M.
Located 2 blocks from Courthouse on the corner of Chestnut and Turman Ave. For the Estate of the late Mrs. G. M. Maxey.

FOR SALE: CPVC plastic pipe 1/2-inch and 1-inch; also ABS plastic pipe and fittings. Special thanks for the prayers, cards, flowers, gifts and to the doctors, nurses and hospital staff. Nettie Marshall. 10-30-11

FOR RENT OR SALE: 2 bedroom mobile home, furnished. Couch for sale. Full air tank, truck camper top for short bed truck. Phone 289-5887. 10-30-11

FOR RENT OR SALE: 2 bedroom mobile home, furnished. Couch for sale. Full air tank, truck camper top for short bed truck. Phone 289-5887. 10-30-11

FOR RENT OR SALE: 2 bedroom mobile home, furnished. Couch for sale. Full air tank, truck camper top for short bed truck. Phone 289-5887. 10-30-11

FOR RENT OR SALE: 2 bedroom mobile home, furnished. Couch for sale. Full air tank, truck camper top for short bed truck. Phone 289-5887. 10-30-11

BUY, SELL, TRADE OR RENT THROUGH THE APSS

MAGICWORD
HOW much do you know? Do you know how to win at a machine? ... MAGICWORD ... PICKING A PRESIDENT ...

NEXT WEEK'S "HOROSCOPE"
FOR WEEK BEGINNING MONDAY, NOV. 3, 1980
If you heralds occurs this week ...

CROSSWORD PUZZLE
ACROSS
1. Word following cable or ship
2. To and ...

IN QUOTES
"Who was that lady?"
"Who was that lady?"

Laugh out
Judge: "What were you doing in that place when you were raided?"

BUYING SCRAP GOLD
SP71 11.28 - 16.05 - 20.97
680 11.67 - 15.57 - 21.68

Garrett's Furniture Co.
A Small Deposit will Hold Any Item

CANDIDATES
RESERVATIONS
DAMEC I O H C E S P E R
S I L O T L O S E U E A P O V
P N U C R A H E C U B O M V
N E L G N P R A S H E B S R E
O E N F L O A C D L R O E M D
I E L E A P T I F E D L E D
N T L I P D A C T K R E W E
H L A D A N A C F O R E
P C O R N A L A O I U T P
E S T C O M P G B N I E L
D E R S O P X E N G D S O A
H E A D Q U A R T E R S N N
I N A G E R L A N O I T A N

CROSSWORD PUZZLE
ACROSS
1. Word following cable or ship
2. To and ...

IN QUOTES
"Who was that lady?"
"Who was that lady?"

Laugh out
Judge: "What were you doing in that place when you were raided?"

BUYING SCRAP GOLD
SP71 11.28 - 16.05 - 20.97
680 11.67 - 15.57 - 21.68

Garrett's Furniture Co.
A Small Deposit will Hold Any Item

Garrett's Furniture Co.
A Small Deposit will Hold Any Item