

The Carlisle Mercury

PUBLISHED EVERY THURSDAY AT 232 LOCUST STREET SECOND CLASS POSTAGE PAID AT CARLISLE, KY. 40311

WARREN R. FISHER Editor-Publisher
MRS. J. KATHARINE FISHER Assistant Editor
Subscription Rates Per Year: In Kentucky, one year, \$3.40 + 10c tax; Out-of-State, one year, \$4.00

Bulging Bankbooks

The other day the Christian Science Monitor's Washington bureau sent an intriguing story. It showed that the American people (despite inflation, the blandishments of advertising, many ill-willed wishes and ambitions) are saving a larger part of the so-called "disposable" income than in recent years. Whereas the average figure for the years 1959-64 was 3.5 percent, by 1967 it had risen to approximately 7.1 percent. This question of how much one needs to spend has become one of another discussion that rises over and over again, and it will continue to do so for the foreseeable future. The economist are never quite sure who such changes in habits come from, but they do know that, from time to time, there is a stability over things in general (and in particular, in the national election uncertainties, etc.)

MERCURY VAPOURS

Sign of Well-being--In our February issue of The Carlisle Mercury we published a list of 250 products from New York which we called the "Mercury list." These are listed in a Christian Science Monitor article in this issue.

While on the C of C--there are 64 paid members as of last Thursday, and its regular meeting falls on the fourth Thursday evening.

Twenty & Fifty-One Years Ago

Thursday, February 19, 1948
The organization of the Younger Women's Club, whose membership was limited to women between the ages of 18 and 30, was announced today. The new club was organized under Mrs. Charles Shourt Jr., president; Miss Helen Ballard and Frances Preston Adams, Mrs. Ralph Steiner, secretary; Mrs. E. R. B. Steiner, treasurer.

VACATION HOUSE

Franklin, Ky.--Gov. Louis B. Nunn is likely to surprise some legislators by giving them his budget message ahead of his Feb. 15 target date set earlier.

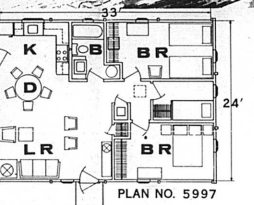

Combustion, convenience, safety, and economy goes into this low-cost vacation house. This building plan features the easy living you find in the most expensive home without reducing their strength, wall panels, trusses, and floor systems are built to last.

LETTERS from our readers

debris and beer cans. Does Carlisle have any "magic" to ensure that it might escape Port Clinton's last? If a business boom did occur, and added population came, it would probably bring national garbage and other clean-up efforts to solicit the local factory and possible efforts, in short, a lot more than river-versus-lake "acrobatic" behavior.

Dear Editor: I am a resident of Nicholas County. I was very pleased to read about the approval of the Nucleon Supplement. I feel that many people can benefit from this "new" product.

Agree Or Not,

I Say What I Think
By S. C. Van Goren

The governor apparently feels the 2-cent boost in sales tax will hurt the lean and be easier to collect. Another advantage is the funds come in monthly and steadily. The tourist business amounts to about \$20 million a year.

There are arguments that the sales tax hurts welfare recipients, but the governor's response to increase welfare checks is to increase the 2-cent boost in sales tax.

Farm & Home

On Washington's birthday, Feb. 22, to which we attach each strip will be about 17"x25". Place a strip of ice cream on each strip, fold the sides of each strip over the ice cream and place in a shallow tray or baking dish in the freezer until ready to use.

Local Business
S. S. Talbot, Chairman
University of Miamis

Printed Advertising A Permanent Record
The government and private groups have renewed efforts to protect the value of the service contract. "Truth in Advertising" legislation of 1937 and 1946 has been passed.

Dear Sir: It has been said "Build a better ship and the world will beat a path to your door." Without proper recognition we doubt that this could have been the Parla Tobacco Mark over the years built a better tobacco market and we are indeed grateful that many tobacco men have made a path to our door, our market having shown



Left to right: Mrs. Reese Smoot, county treasurer; Mrs. Paul Wilson, nursing county secretary; Mrs. George Dale, outgoing county president; Mrs. Gretchen Varner, present bluegrass area president; Mrs. Maurice King, outgoing county vice-president.

Saltwell

Mrs. Jeanne M. Mattox visited her brother, William H. Mattox on Wednesday night and Thursday. Mrs. Mattox is critical ill in the Veterans Hospital in Lexington.

Service Your TV or Radio... For a FREE Estimate... DUNCAN'S ELECTRICAL SHOP

FIRST TIME EVER! A McCulloch Chain Saw with AUTOMATIC OILER at this low price!

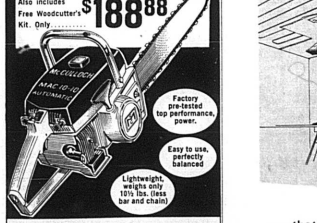

NEW MAC 10-10 AUTOMATIC SELF-OILING CHAIN SAW BY McCULLOCH
No more manual oiling of bar and chain. It's automatic! saves work and saves you big money.

FREE with purchase of McCulloch 10-piece Woodcutter's Kit... (ESS RETAIL VALUE) New! Formulas for the home and business use. Includes active and blind guide.



The new officers for the Nicholas County Homeowners Association installed at the 22nd annual meeting: (left to right) Mrs. Reese Smoot, vice-president; Mrs. Robert Chanda; secretary; Mrs. Maurice King, treasurer; and Mrs. Jeanne Mattox, treasurer.

Myers

Miss Virginia Mattox visited Kahan Kinder Sunday. Mr. and Mrs. Gilbert Steen and children of Johnson spent the weekend at Mr. and Mrs. Ronald George and Mrs. Frank Parke.

W.S.C.S.

The women's society of Christian Service of the Saltwell Methodist Church held their regular monthly meeting Wednesday, Feb. 7 at the home of Mrs. Fred Holler.

The sun's up there, not on the ground... The sun's up there, not on the ground. That's why modern electric ceiling cable feels like radiant sunshine.

GE Porta-Color TV to be given away Thursday, Feb. 29th

GE's GARDNET'S FURNACE... COME in And REGISTER... Six rate reductions since 1962.



Twenty year members of the Nicholas County Homeowners Association were awarded plaques by Mrs. George Dale at the annual meeting. (left to right) Mrs. Carl Moore, Mrs. Gifford Capwood, Mrs. Anne Abbott, Mrs. Francis W. Moore, Mrs. Robert Chanda, Mrs. Gilbert Terrell, Mrs. Albert Hays and Mrs. John Winters.

"What I want most out of the Homeowners program this year..." The devotion was given by Mrs. Jo Smart. The reason, "Color through the society was discussed by Mrs. Paul Judge, who showed pictures also. Our music appreciation team, a tape recording of a symphony, bringing out the different instruments of the orchestra, was presented by Mrs. Wilcox and Mrs. Betty Livingston.

Moorefield Homeowners... Mrs. Joe D. Blount was honored at the Moorefield Homeowners for the February meeting. We were so glad to have 100% of our members present.

Advertisement for GE Appliances, Television, and Stereo. Features GE Refrigerators, Freezers, and Washers. Includes promotional offers like "148" and "148.98".